

LEWMAR

B5676-

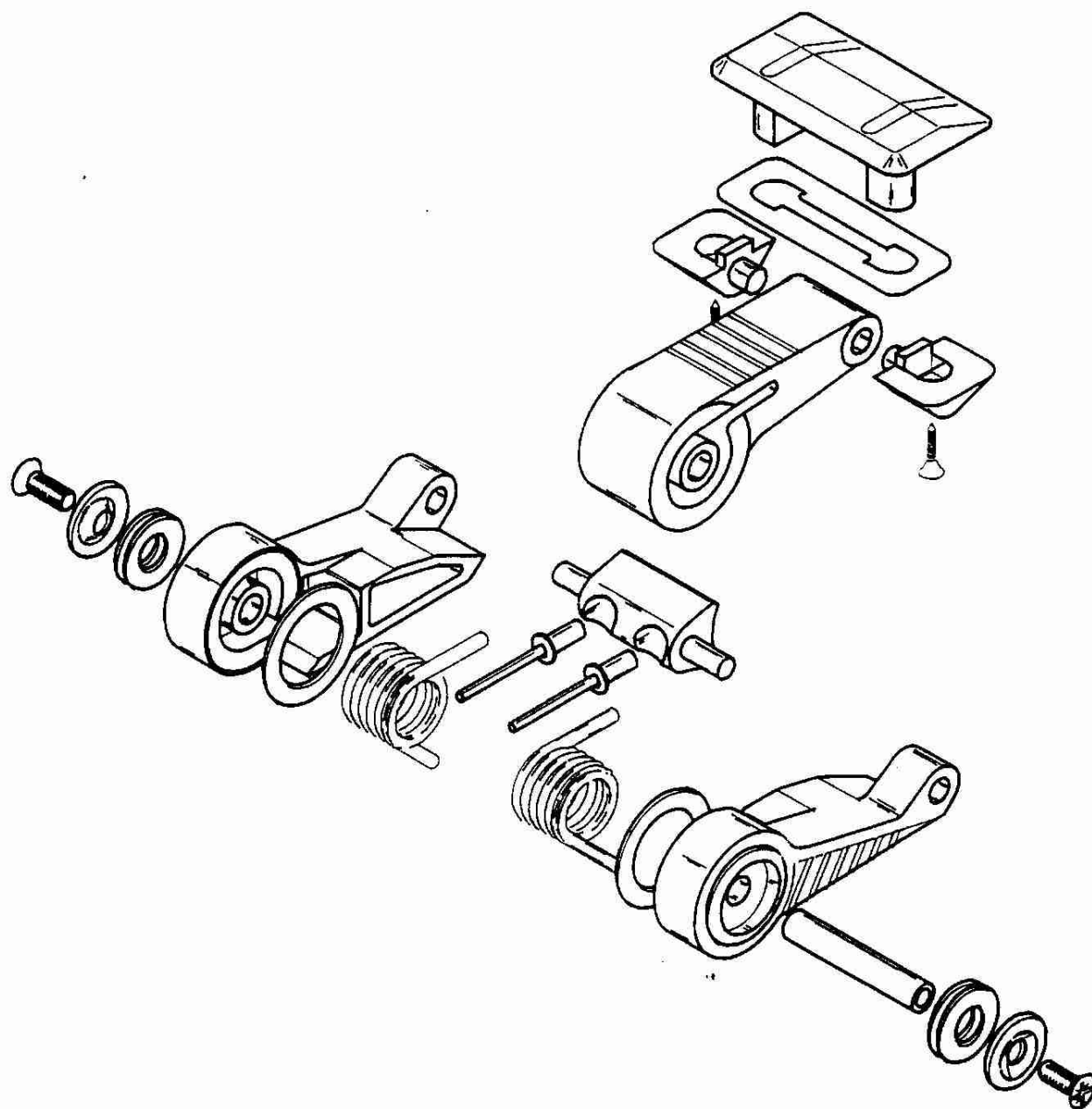

KIT No.	USED ON
36027299Z	OCEAN 30-50, COASTLINE TO 65
36027399Z	OCEAN 50 UP, COASTLINE 65 UP

REFER TO TABLE 'Z' FOR COLOUR VARIANTS

HATCH SPARE PARTS

LARGE FRICTION LEVER KITS

ISSUE 1.1 DATE 19.6.92

LEWMAR

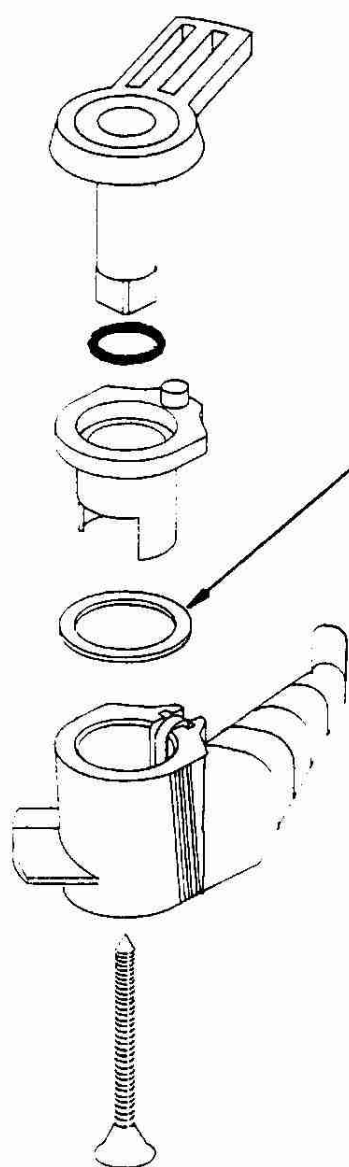

NOT REQUIRED FOR:
 ROLLSTOP SIZE 30
 OCEAN SIZE 30 & 40
 COASTLINE ALL SIZES

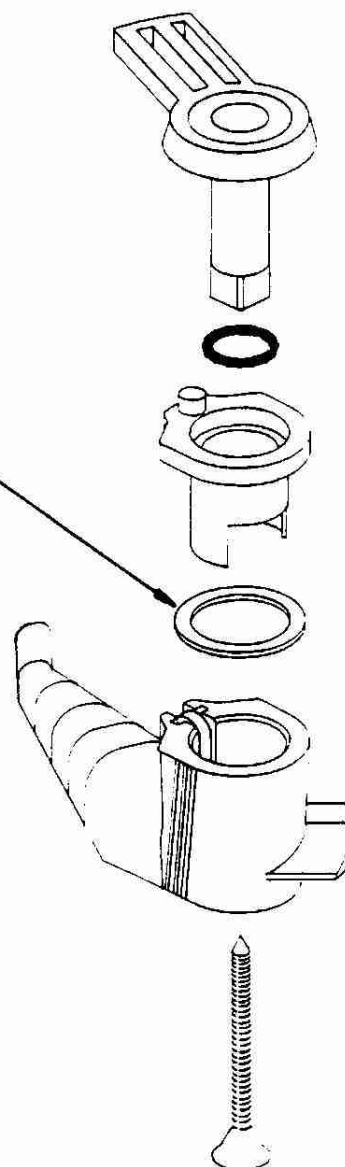

KIT No.	36024999Z	L.H.
---------	-----------	------

KIT No.	36025099Z	R.H.
---------	-----------	------

REFER TO TABLE 'Z' FOR COLOUR VARIANTS

HATCH SPARE PARTS

USED ON ALL HATCHES SIZE 30 OR LARGER

LARGE HANDLE KIT

ISSUE

1.2

DATE

17.7.92

LEWMAR

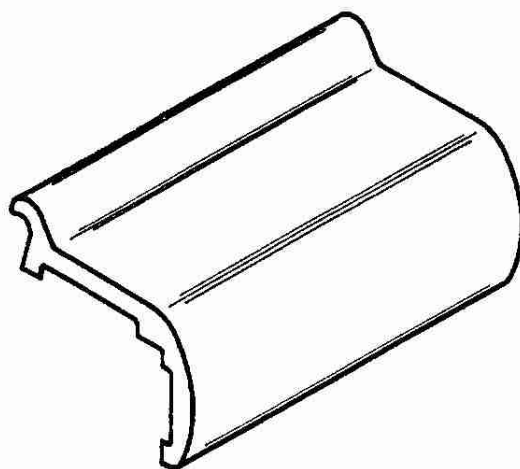

LOWER FRAMES ARE SUPPLIED COMPLETE WITH HANDLE CATCH BLOCKS AND LEVER PIVOTS FITTED.

KIT No.	HATCH SIZE
3601479YZ	30
3601489YZ	35
3601499YZ	40
3601509YZ	45
3601519YZ	50
3601529YZ	60
3601539YZ	65
3601549YZ	70
3601559YZ	75

REFER TO TABLE 'Y' FOR FRAME COLOUR VARIANTS
AND TABLE 'Z' FOR MOULDING COLOUR VARIANTS

COASTLINE SPARE PARTS

LOWER FRAMES

ISSUE

1.1

DATE

16.6.92

LEWMAR

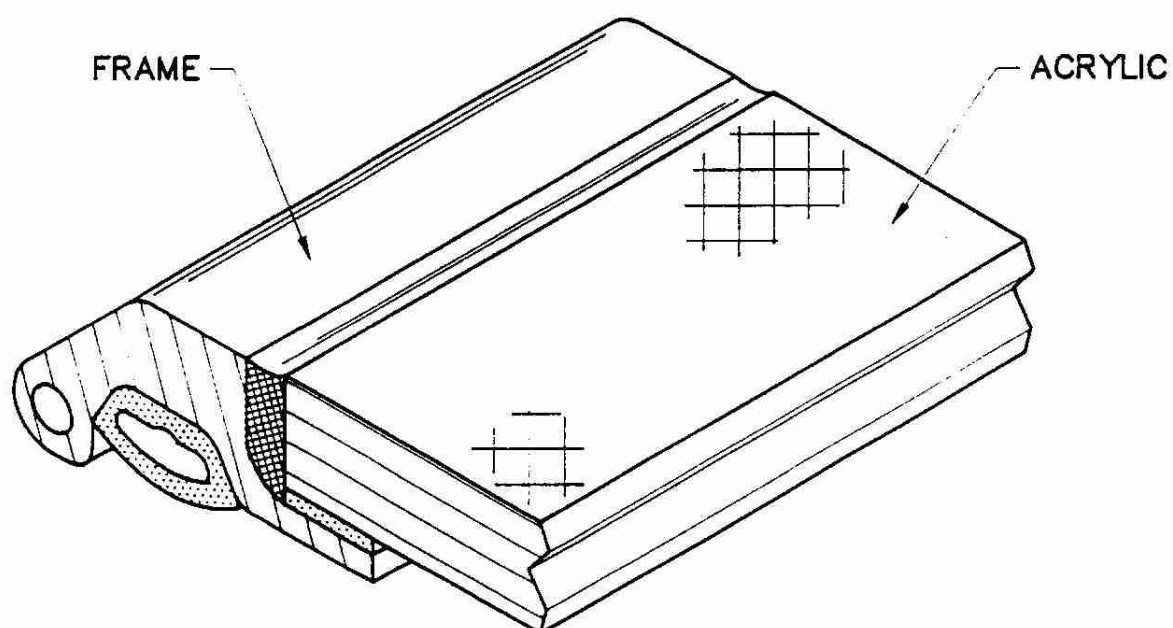

KIT No.	HATCH SIZE
360160XY9	30
360161XY9	35
360162XY9	40
360163XY9	45
360164XY9	50
360165XY9	60
360166XY9	65
360167XY9	70
360168XY9	75

REFER TO TABLE 'X' FOR ACRYLIC COLOUR VARIANTS
AND TABLE 'Y' FOR FRAME COLOUR VARIANTS

COASTLINE SPARE PARTS

UPPER FRAME

ISSUE

1.1

DATE

16.6.92

LEWMAR

B5622-1

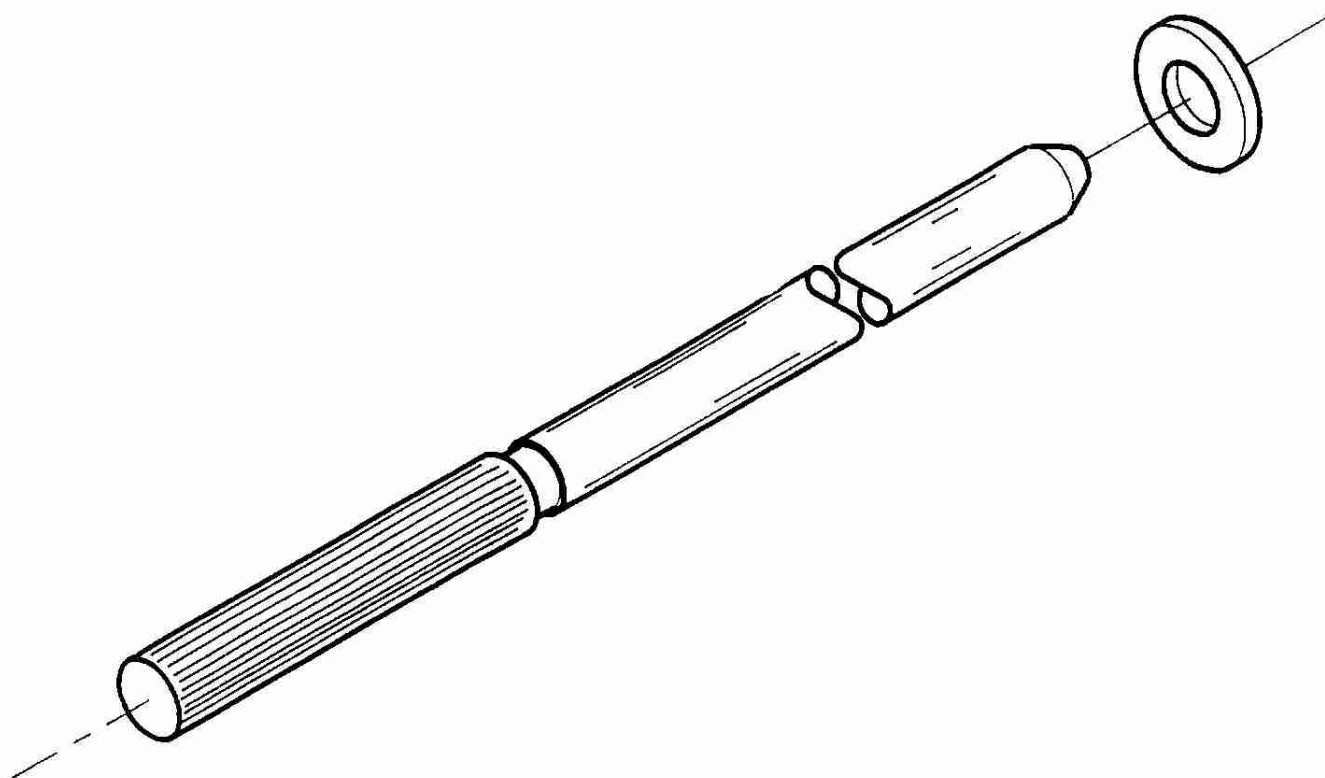

KIT No.	HATCH SIZE
360174999	30,35,40,45,50,60 & 65
360175999	70
360176999	75

COASTLINE SPARE PARTS

HINGE PIN KITS

ISSUE

1.1

DATE

16.6.92

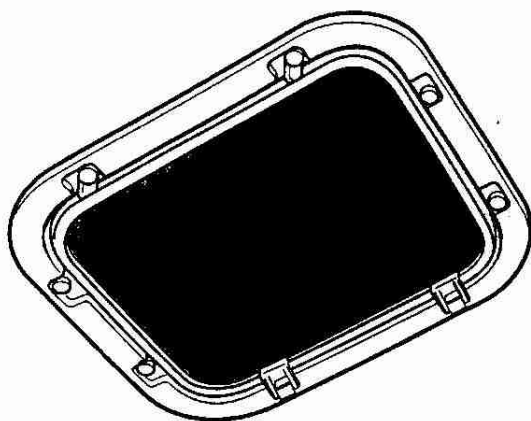

Retro Fit Hinge for Hatch Flyscreen (With Alloy Frame) Fitting Instructions

B2184 Issue C

LEWMAR®

Retro-fit Flyscreen Fitting Instructions (Trim in Position)

B2184 Issue C

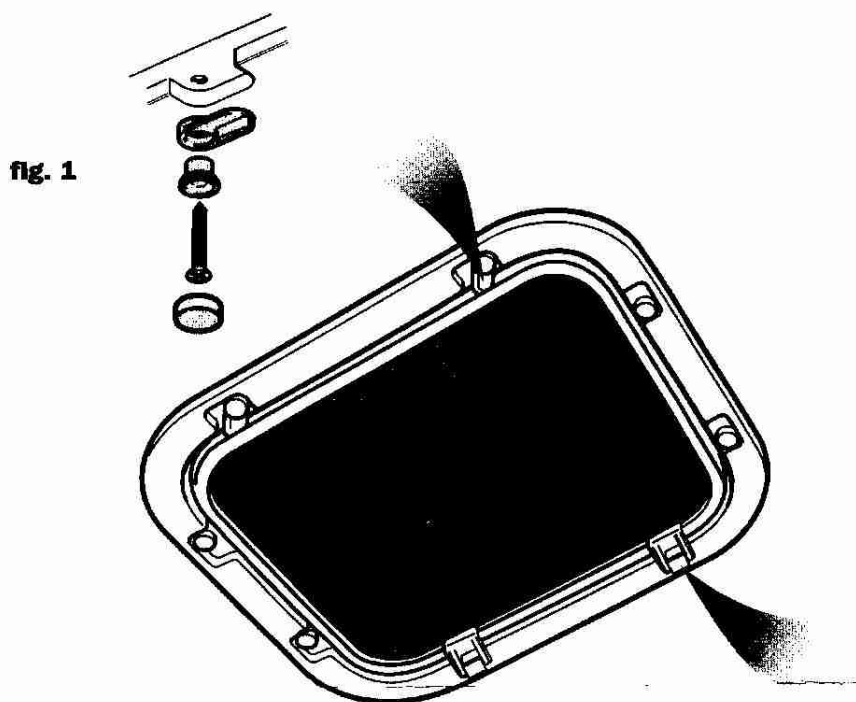

fig. 1

2. LOCK & SPACER

If locks were not originally fitted, remove fastenings in the locations shown. Replace with the lock assembly provided. Tighten the screws but ensure the lock can still swivel. See fig 1.

2. FRAME HINGE

Unscrew original spacers and caps. Replace with new hinge bracket assembly. See fig 2.

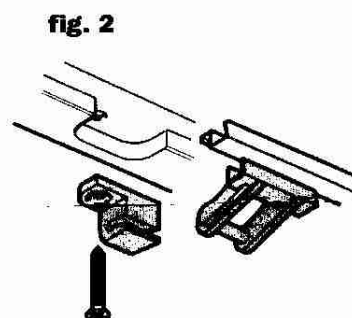

fig. 2



USER NOTES

- Use soapy water and a soft cloth. **Do not** under any circumstances use solvent cleaners.
- When the flyscreen is not in use, place in a safe area to protect the mesh.

3. LOCKING

The flyscreen is held by placing its mesh face towards the trim and rotating the locks 45 degrees to hold, see fig. 3

fig. 3

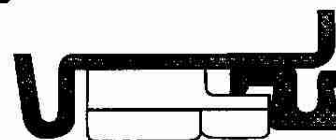

Hatch Trim & Flyscreen Fitting Instructions

B2184 Issue C

1. TRIM MOLDING

Adjust the trim molding to suit your deck thickness, see fig. 1 below, by cutting the inner edge only.

fig. 1

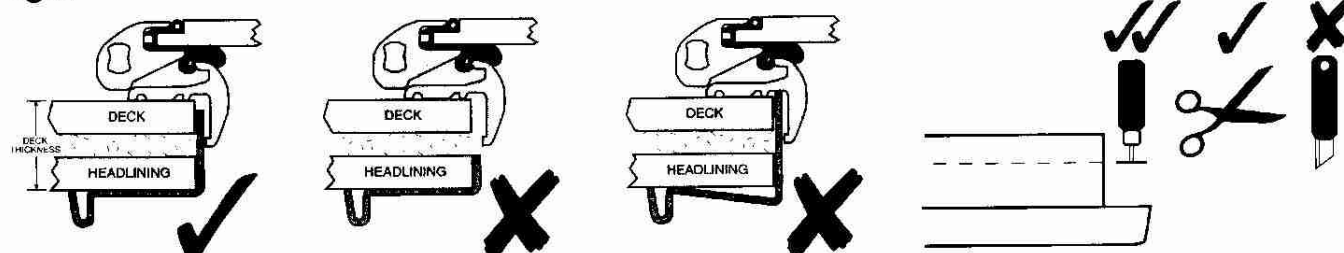

fig. 2

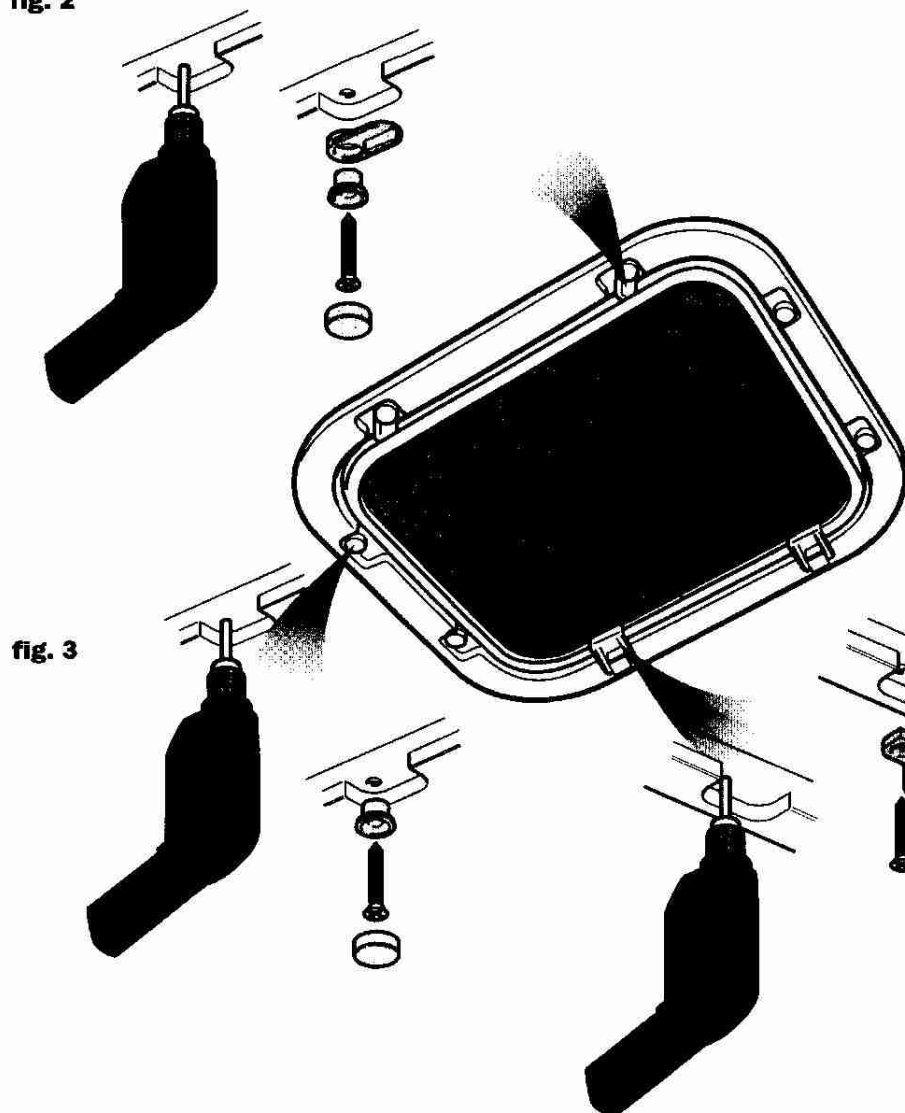

fig. 3

2. LOCK & SPACER

Position the trim under the hatch. Using the holes in the trim as guides, drill 4mm or ($\frac{5}{32}$ ") holes for the fastenings. Assemble the locks as shown, see fig 2, and fasten with the screws provided. Tighten the screws but ensure that the locks can still swivel. Repeat with the spacer only in the areas shown, see fig 3.

3. FRAME HINGE

Position the trim under the hatch. Using the holes in the trim as guides, drill 4mm or ($\frac{5}{32}$ ") holes for the fastenings. Fasten the hinge bracket. Affix the hinge over the flyscreen and clip to the hinge bracket, see fig 4.

fig. 4

4. LOCKING

The flyscreen is held by placing its mesh face towards the trim and rotating the locks 45 degrees to hold, see fig. 5

fig. 5

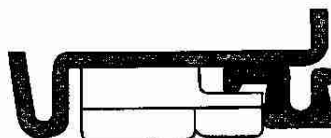

USER NOTES

- Use soapy water and a soft cloth. **Do not** under any circumstances use solvent cleaners.
- When the flyscreen is not in use, place in a safe area to protect the mesh.