

Catalina // *Yachts*



Get Your Dream's Worth.

The Catalina 387 represents a high point in the evolution of the modern cruising boat.



Wide, uncluttered weather decks



The longest, most comfortable cockpit in 38 feet.

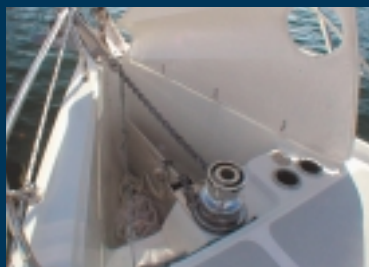

Divided anchor locker with 2 rollers and electric windlass with up and down switches

The Catalina 387 is a beautifully proportioned modern cruising yacht, graced with the functional details, amenities and equipment that mean the most to the knowledgeable and experienced cruising sailor.

A bigger, more functional cockpit design.

The large cockpit, with Edson Diamond Series pedestal, fitted with a custom fiberglass instrument housing, integrates all navigation and engine displays. 9-foot seats port and starboard are unique in a yacht this size. Not only do they make sail trimming an uncomplicated maneuver, but at anchor, provide more than ample room to stretch-out or dine in comfort. With the aid of a large, integrated, folding leaf table, cockpit dining is un-cramped, convenient and relaxing. Deep lazarettes, port and starboard will swallow all the gear and toys needed at any destination. Aft, a walk-through transom serves as easy entry and exit with two storage lockers and hot water shower conveniently located nearest the water. Built-in stern rail seats, with integrated outboard motor bracket, add yet another aspect to the more than abundant cockpit seating.

A powerful rig made easy to handle.

All lines are lead aft to the cockpit where sail handling can be easily accomplished with a minimum of crew, even singled handed. A masthead rig allows use of powerful genoas in light air. The fully supported mast with double spreaders and a stainless steel boom vang assures strength and durability offshore. An efficient fully battened main with an easy to handle Dutchman flaking system is standard or your choice of internal mast or boom furling are available as are an electric winch. Two internal genoa halyards are standard. Durable Garhauer sailing hardware, including low friction ball bearing blocks are used throughout.



A sleek and graceful silhouette belies the interior volume of the 387.

The main salon is large and makes full use of the 12'-4" beam. The 6'-9" headroom and many screened in opening ports and hatches provide for an extraordinarily light and open feeling below. After dark, recessed, directional halogens infuse the cabin with light. Every amenity, feature and accommodation for comfortable cruising for up to seven has been included. High quality teak veneer bulkheads, solid teak cabinetry, doors and shelves are stylish and easily maintained. Seating features sculpted cushions upholstered in a choice of designer fabrics or premium Ultra-Leather™. Four table configurations in the main salon provide the ultimate in versatility, they include: large dining table, extended dining table, cocktail and game table.

The large galley means cooking aboard without compromise.

A stainless steel double sink with sprayer faucet is located nearest the centerline, exactly where it should be. With additional crew aboard, a large top loading storage locker in the counter to port will double as a second refrigerator. Above the locker are two large storage cabinets that open down for safety and complete accessibility. A gimballed, three burner stainless steel stove, 6 cubic foot refrigerator with access top and side and an over the counter microwave complete this spacious and beautifully appointed galley.

More boat, more value, more Catalina.

Not only will a Catalina pay extraordinary dividends in dependable systems and gear, comfortable ocean cruising and seakindly design, but as every Catalina owner will attest, at resale, a Catalina will retain among the highest percentage of original investment. The 387 is every inch a Catalina, she is the collective result of over 35 years of boat building experience and the input from thousands of cruising sailors. And the 387 meets or exceeds the most stringent building certification standards. She is the current high point in the evolution of the modern cruising yacht.



Extended dining table and settee



Complete electrical panel with room for expansion



Unrestricted engine access fore and aft



Guest cabin forward, with plenty of natural light and ventilation



The classic L-shaped galley has been updated to a new level of utility and function, not mention eye appeal.



Master cabin aft, with huge athwartship innerspring mattress

Graciously accommodating owner and guests.

The well ventilated forward cabin with double berth, thick innerspring mattress, a large hanging locker and plenty of drawer storage offers a comfortable and private retreat for guests. The huge master stateroom, aft, features a huge, full beam, over 8-foot long berth with innerspring mattress, two hanging lockers, cedar lined drawers and large storage bins. The adjacent head compartment features a full stall shower, vanity with sink and three convenient storage lockers. You have a choice of a centerline fore and aft berth or the extra long athwartship berth.



Catalina design quality means a roomy head with three lockers, separate stall shower with it's own bi-fold door .





Catalina 387

Principal Specifications

Length Overall		12.14 m	39' - 10"
Length of Hull		11.81 m	38' - 9"
Length at Waterline		9.88 m	32' - 5"
Beam		3.76 m	12' - 4"
Draft	Fin Keel	2.18 m	7' - 2"
	Wing Keel	1.47 m	4' - 10"
Ballast	Fin Keel	3084 kg	6800 lbs.
	Wing Keel	3311 kg	7300 lbs.
Displacement	Fin Keel	8618 kg	19,000 lbs.
	Wing Keel	8845 kg	19,500 lbs.
Engine		40 HP	3 cylinder
Sail Area (100% Foretriangle)		66.80 m ²	719 sq. ft.
I		15.52 m	50' - 11"
J		4.47 m	14' - 8"
P		13.46 m	44' - 2"
E		4.78 m	15' - 8"

All measurements are approximate and subject to change without notice.

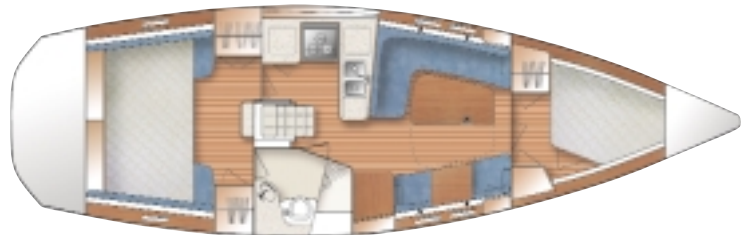

Catalina 387 with athwartship master cabin berth.



Catalina 387 with centerline master cabin berth

Catalina **Yachts**

21200 Victory Boulevard
Woodland Hills, CA 91367

Phone (818) 884-7700
FAX (818) 884-3810

www.catalinayachts.com

member: **ABYC**
Setting the Standards for Safer Boating

member: Certified National Marine
Manufacturers Association



Sold and Serviced by:

Photos and drawings may show optional equipment.
Refer to current price sheet for standard equipment list and specifications. Wood is a natural material, color and patterns may vary from the boat shown in photos.